

**T D - s e r i e s**

PV-TD 190MF5 190Wp

PV-TD 185MF5 185Wp

PV-TD 180MF5 180Wp

PV-TD 175MF5 175Wp

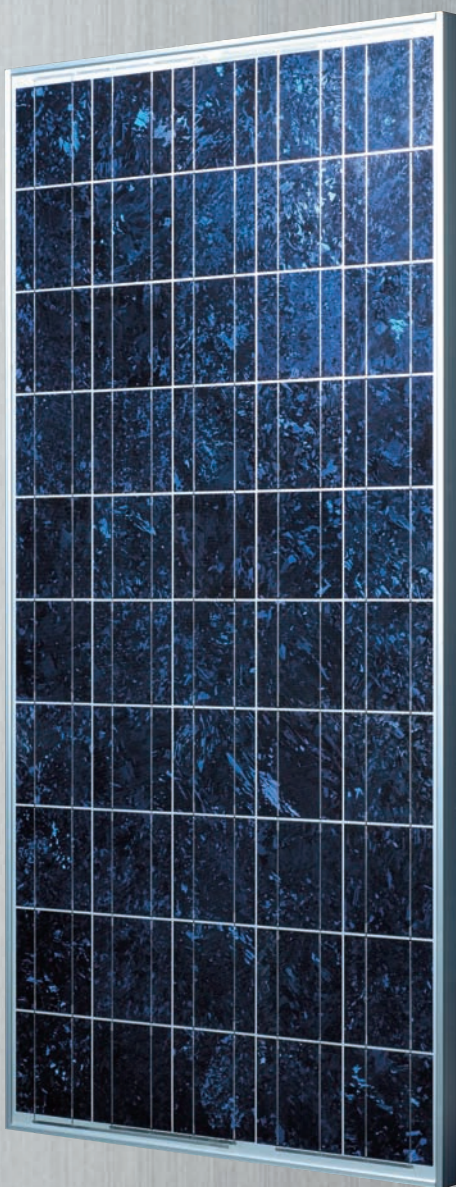

**T  
i  
n  
Q  
u  
a  
l  
i  
t  
y**

**High Efficiency**

- Solder-coatingless cells
- Fine Grid Electrodes
- BSF (Back Surface Field) optimizes cell efficiency
- Anti-Reflective Coating
- Unique Bus Bar Design
- Back Film Reflected Light
- High Reflectance Back Film
- Cerium-Free / High-Transmittance Glass
- Tightest Tolerance: +/-3%
- High Power in Actual Use

**High Reliability**

- Double-sided, independent assembly connections
- Lower slope by 30%
- Water-tight connector plug
- Higher Static Load Test 5400 Pa passed with Protection Bar
- Stable aluminum frame, optimally protected against corrosion
- Smart drainage system
- Max. System Voltage 1000V with Four-Layer Structure Back Film

**High Safety**

- Fire-protected connector box
- Reliable bypass diode
- Lock Mechanism Equipped Connectors
- Meets IEC61215 (2nd edition), EN61730, TÜV safety class II

**Eco-Friendly**

- Lead-free solder PV module
- Fabrication certified to environment management standard ISO 14001
- Recyclable metal transport pallets



## Specification Sheet

Manufacturer	MITSUBISHI ELECTRIC			
Model name	PV-TD190MF5	PV-TD185MF5	PV-TD180MF5	PV-TD175MF5
Cell type	Polycrystalline Silicon, 156mm x 156mm			
Number of cells	50 cells in a series			
Maximum power rating (Pmax)	190W	185W	180W	175W
Warranted* minimum Pmax	184.3W	179.5W	174.6W	169.8W
Tolerance of maximum power rating	+3 / -3%			
Open circuit voltage (Voc)	30.8V	30.6V	30.4V	30.2V
Short circuit current (Isc)	8.23A	8.13A	8.03A	7.93A
Maximum power voltage (Vmp)	24.7V	24.4V	24.2V	23.9V
Maximum power current (Imp)	7.71A	7.58A	7.45A	7.32A
Normal operating cell temperature (NOCT)	47.5 degree C			
Maximum system voltage	DC 1000V			
Fuse rating	15A			
Dimensions	1658 x 834 x 46mm (65.3 x 32.8 x 1.81 inch)			
Weight	17kg (37.0 lbs)			
Output terminal	(+) 800mm / (-) 1250mm with MC connector (PV-KBT4/6II-UR, P-KST4/6II-UR)			
Module efficiency	13.7%	13.4%	13.0%	12.7%
Packing condition	2 pcs - 1 carton			
Certificate	IEC 61215 edition 2 (static load test 5400 Pa passed), EN 61730, TUV Safety Class II			

## \*Quality Guarantee

Guarantee of material quality:  
**5 years**

Guarantee of power rating:  
**10 years** time the modules will reach 90% of Pmax  
minimale garantie

**25 years** time the modules will reach 80% of Pmax  
minimale garantie

Detailed conditions you can get at your local dealer.

## Drawings and Dimensions

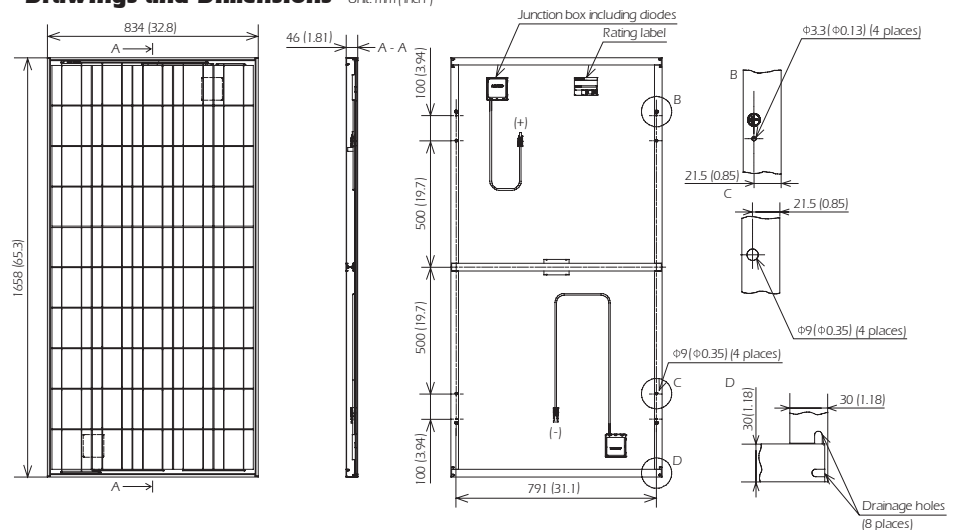

## Electrical Characteristics

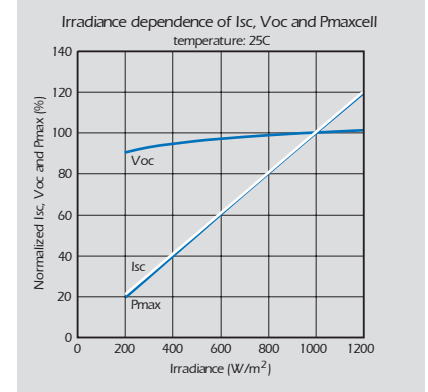
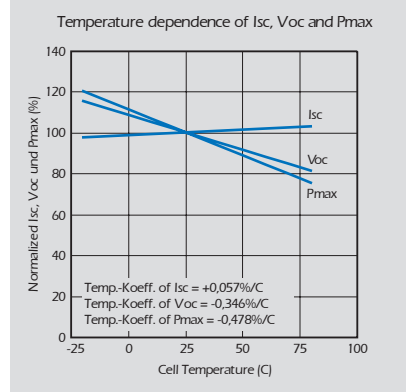
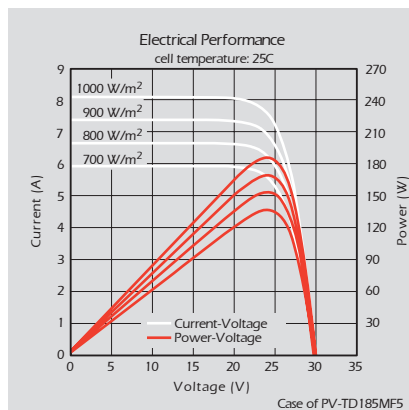

 **MITSUBISHI ELECTRIC CORPORATION**

Your dealer is:

**Mitsubishi Electric Europe B.V.**  
Photovoltaic Division  
Gothaer Str. 8  
D-40880 Ratingen  
Phone: +49 (0) 2102 486 1593  
Fax: +49 (0) 2102 486 1537  
Web: www.mitsubishi-pv.de  
E-Mail: info@mitsubishi-pv.de

Printed in Germany /// © Mitsubishi Electric Europe B.V. /// Specifications and design subject to change without notice. We can accept no liability for any errors. /// 05/2008